

RC1T

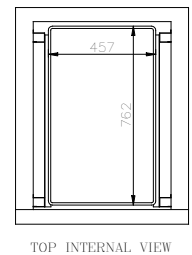

CATEGORY	FOODSERVICE UPRIGHTS
RANGE	Crystal Bakery
UNIT	RETARDER
TYPE	SELF CONTAINED
DOORS	1

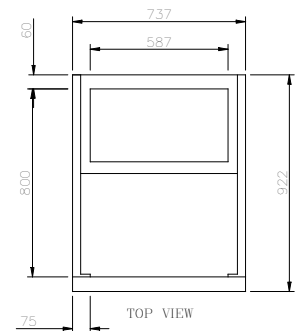
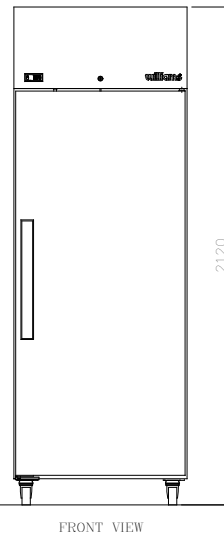
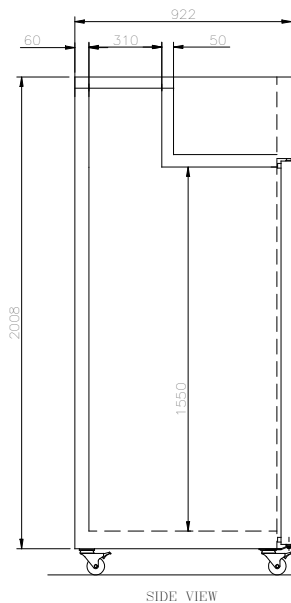

SPECIFICATIONS

CAPACITY LITRES	730
TEMPERATURE - 43°C AMBIENT ENVIRONMENT	-5°C / +3°C
DIMENSIONS - W X D X H (ON CASTORS) MM	737 W x 922 D x 2120 H
WEIGHT UNPACKED (KG)	160

STANDARD INCLUSIONS ***

DOOR TYPE	Standard: S (Solid Door)
FINISH (INTERIOR & EXTERIOR EXCLUDING REAR & UNDER)	S (Stainless Steel) CB (White)
TRAY SLIDES PER DOOR (NO TRAYS OR SHELVES SUPPLIED)(ACCOMODATES 18" OR 16" TRAYS)	20

ELECTRICAL

POWER SUPPLY	10 amp
POWER CABLE LENGTH (METRES)	2
RUNNING AMPS	4.0

GAS TYPE

REFRIGERANT	R134a
-------------	-------

REFRIGERATION WATTAGES FOR OPTIONAL REMOTE UNITS

FRIDGE MODELS - SOLID DOORS	520 @ -5°C SST
-----------------------------	----------------

*** For **OPTIONS** refer to the current Williams Price Guide