

## Six Drawer, Two Bay, Underbench GN 1/1 Fridge

**Range:** ProSpec  
**SKOPE ID:** P1BR2-A4  
**Dimensions:** 1290 mm (W) × 700 mm (D) × 850 mm (H)  
**Gross Volume:** 288 L

**Project:** \_\_\_\_\_

**Item #:** \_\_\_\_\_



A six drawer underbench fridge designed for busy kitchens at venues such as restaurants, clubs, pubs, and cafés. The fridge is engineered to safely store food in ambient environments of up to 40°C (climate class 5). With GEMS-certified 5M1 performance, standard storage temperatures range from 1°C to 4°C, or are adjustable via the SKOPE-connect smartphone app for specific food types from -2°C to 15°C. The fridge is made from food-safe 304 AISI stainless steel throughout the interior and exterior. The 700 mm deep cabinet with a fully welded and integrated worktop can be configured to suit multiple installation options. At 850 mm overall height, it can be positioned under a bench on the supplied castors, positioned on a pre-installed plinth by removing the castors, or fitted with optional legs for a finished working height of 900 mm. The six GN-compatible soft-closing drawers are fitted with ergonomic 3 mm gauge stainless steel handles and built-in barrel locks. The fridge is fully configurable, with the drawers swappable for either solid door or two GN drawer bays. The slim left-hand service compartment features an easily removable and cleanable condenser filter. The fully removable refrigeration cartridge uses R290 natural refrigerant for low energy consumption, low heat discharge and low noise output. Right-hand services are also available. It is fully front breathing with no side or rear clearance space required and can be easily removed in line with best practice for safe servicing of flammable refrigerants. The fridge includes a smart controller that connects to the free SKOPE-connect app to enable you to set temperatures and alerts, monitor temperatures and energy, and more. The fridge is certified to all Australian and New Zealand refrigeration and electrical safety standards.



Warranty



Natural Refrigerant



GEMS



ChillGuard



304 Stainless Steel



GN-compatible



SKOPE-connect

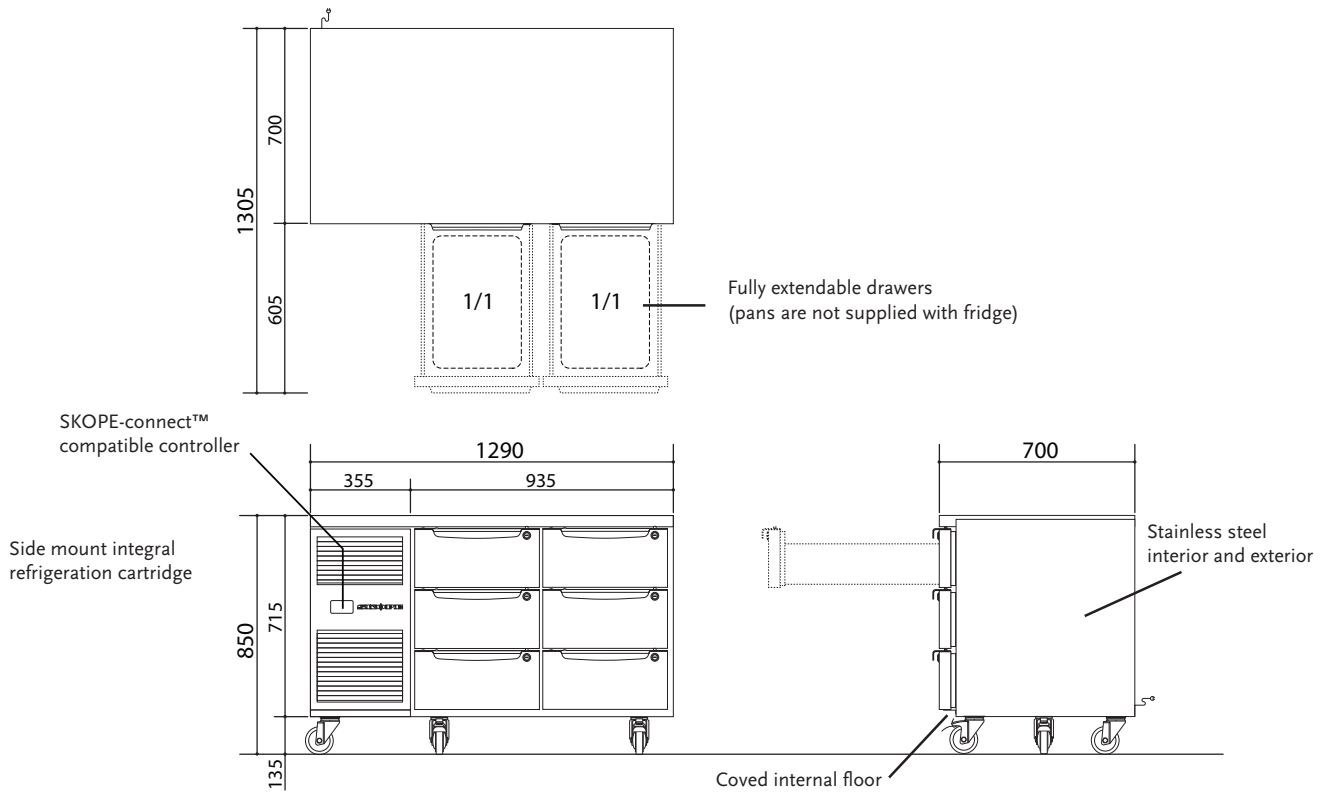

### Cabinet

Type	Underbench		
Finish	304 AISI stainless steel		
Insulation	Type	PU foam	
	Thickness (mm)	50	
	Blowing Agent	Cyclo-iso pentane (C5H10/C5H12)	
Drawers	Lock	barrel lock	
	Width (mm)	300	Depth (mm) 525
Gastronorm	Size 1/1		
Lighting*	None		

### Dimensions†

	External	Internal	Packed
Width (mm)	1290	820	TBC
Depth (mm)	700	580	TBC
Height (mm)	850 (standard castors)	605	TBC
	860 to 900 (legs)		
	715 (plinth mount)		
Weight (kg)	142 [TBC]		TBC
Gross Volume (L)	288		
Footprint (m <sup>2</sup> )	0.9		

### Ventilation (mm)

Top	Sides	Rear
Not required	Not required	Not required

### Dimensional Tolerances

† Allow for dimensional tolerances when installing the cabinet(s).

Linear dimensions	Single cabinet		Multiple cabinets	
			At each joint	At each end wall
Less than 1 metre	±5 mm	±5 mm	+15 mm	
More than 1 metre	-5 mm to +10 mm		-5 mm to +10 mm	

### Performance

Product Temperature Range (°C)	1 to 4 (adjustable* from -2 to +15)	
Maximum Ambient Temperature (°C)	40	
Sound Level (dB(A))	Standard	TBC
	Hush Mode*	TBC

### Greenhouse and Energy Minimum Standards (GEMS)

Star Rating	6	
Product Temperature Class	5M1 (-1 to 5°C)	
Total Energy Consumption	2.10 kWh/24 h	
Annual Running Costs	\$230 (@ \$0.30/kWh)	

### Electrical

Supply	220-240 volts a.c., 50 Hz, single phase supply	
Cord	2 m power cord with 3-pin, 10 amp plug	
Current draw (A)	2.0	

### Refrigeration

Controller	SCS Connect (SKOPE-connect™ compatible)		
System Type	Removable cartridge		
Cartridge Weight (kg)	30		
Refrigerant/Charge	R290/80 g		
Nominal Capacity (W)	TBC		
Heat Rejection (W)	Average	TBC	Peak TBC
Defrost Type	TBC		
Drainage	No plumbing required		

\* Accessible via the free SKOPE-connect™ app.



PG11.UBR.2.D6  
on the SKOPE website