

Supermarket Equipment KREA 260.3 N



PRODUCT CATEGORIES



TECHNICAL FEATURES





ACCESSORIES

TECHNICAL INFORMATION

Width (mm)	2505
Depth (mm)	899
Height (mm)	872
Volume in Litres Gross	1172
Volume in Litres Net	767
Operating Temperature from	-25 °C
Operating Temperature to	-18 °C
Climate class	3 / L1
Cooling System	Static
Refrigerant Gas	R290
Energy Consumption kwh/24H –Class 3 Ambient 25°C –Ur 60%	7,70
Defrost System	Semiautomatic
Gross Weight (kg)	202
Net Weight (kg)	162
Package Dimensions (mm) (W x D x H)	2625 x 980 x 1010



KREA 260.3 N

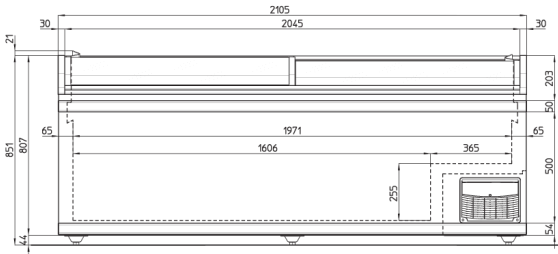

KREA 260.3 N

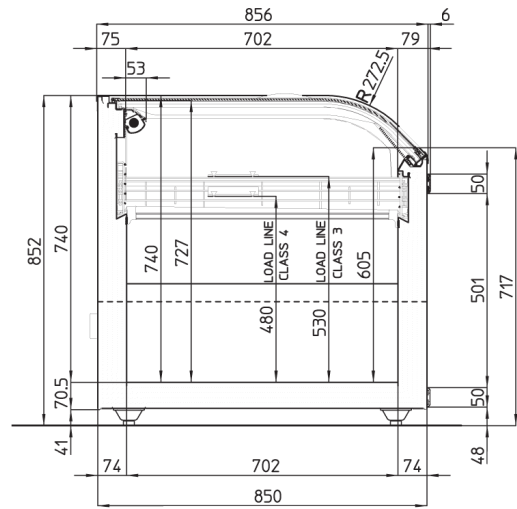

KREA 260.3 N

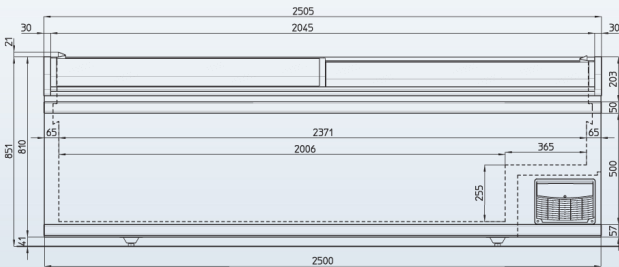



LEGEND



Sandwiches



Wines



Pharmaceuticals



Pastries



Dairy products



Ice creams and Frozen food



Fruit and Vegetables



Cheese



Meat



Drinks



LED lighting



Propane Refrigerant Gas (R290)



R600 / Isobutane



High efficiency fans



On board condenser



Electric controller



Free maintenance condenser



Incorporated condensing unit



R-134a



R404a – 400V/3PH/50Hz



Electric defrost



Off-cycle defrost



Hot-gas defrosting system



Manual defrost



Static



Ventilated



Compressor Hermetic Reciprocating