

# SWING

SERVE-OVER PATISSERIE COUNTER



## FEATURES INCLUDE:

Curved lift up glass  
2 levels of refrigerated display  
2 levels of non-refrigerated display  
Rear slide out drawers  
Front glass demister  
2 levels of internal lighting incl. switch

Rear perspex slides  
Electronic temperature control  
Condensation removal via hot  
gas discharge  
Castor wheels (optional)

# SWING

## SERVE-OVER PATISSERIE COUNTER

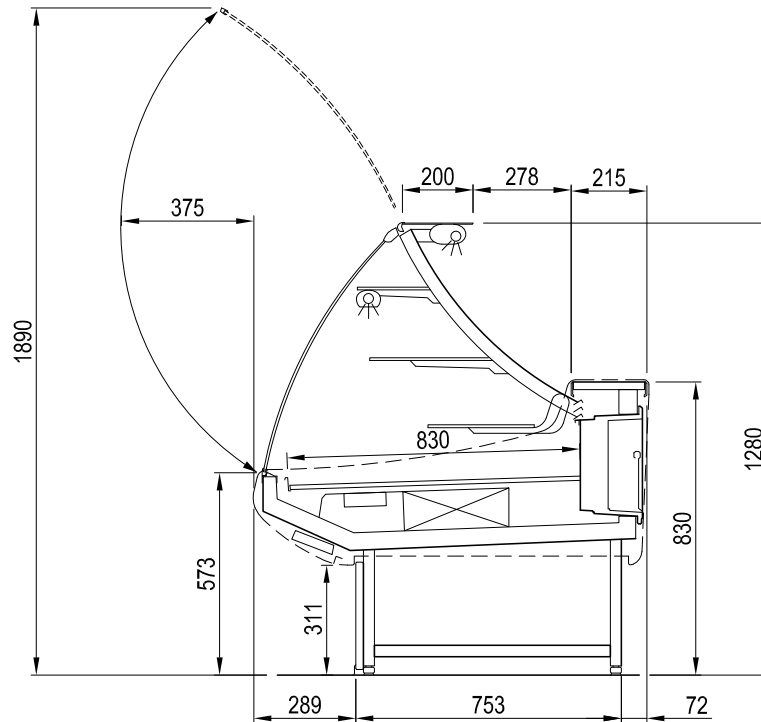

SWING	937.5
* Operating Temp (°C)	+2/+4
Refrigeration	Ventilated/R404a
Defrost	Automatic
Power Supply	230V/1Ph/10 Amp plug
Operating Current (Amp)	1.7
Nominal Power (W)	390
Energy Consumption (kWh/24h)	7
Display Surface (m <sup>2</sup> )	1.10
Total Non-Refrigerated Shelf Area (m <sup>2</sup> )	0.46
Length w/o endwalls (mm)	937.5
Endwall width (mm)	50
Height w/o castors (mm)	1280-1300
Height incl. castors (mm)	1350
Depth incl. bumper (mm)	1114
Weight w/o packaging (kg)	118

\* Climate class 3 (25 C, 60% R/H)  
1875 length available on request